

KNIFE GATE VALVE

PE100 / PN2-6 bar

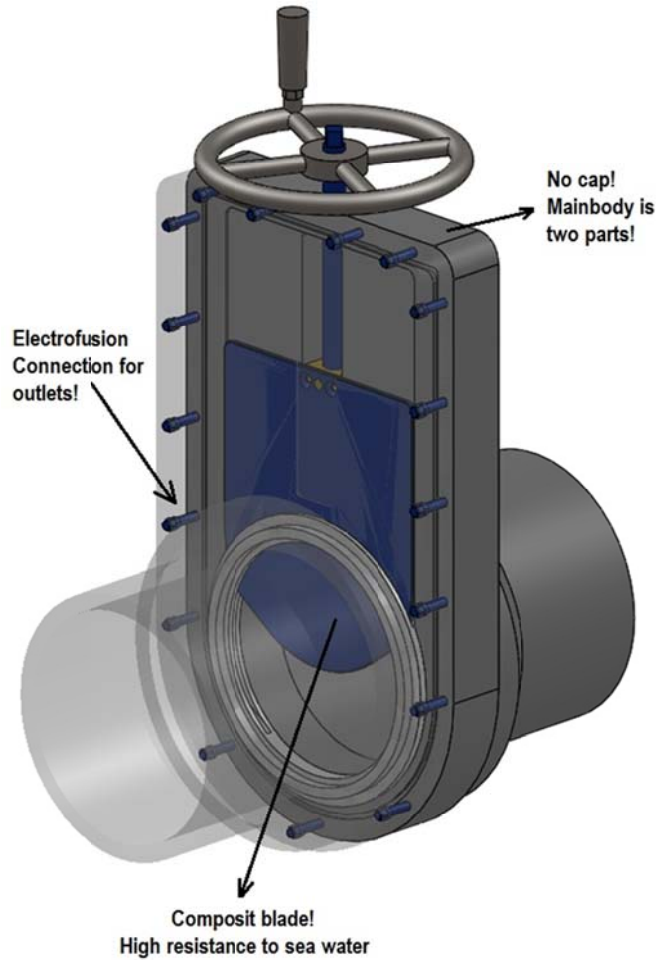



#### ADVANTAGES

- EF connection between body and arms provides zero leakage. (No hand made extruder welding on it!)
- The knife is produced from composit resist to sea water and chemicals better than stainless steel.
- PE100 Body: It has 60 years lifetime.
- (Lifetime is guaranteed by aging test at 80°C test pool)
- Maintenance free due to **no grove** for sealing.
- (Smoothness of the valve prevents accumulation of dust, particles etc.)
- Corrosion is not observed because of PE100 main body.
- It has low weight.
- If water freezes in the body, it will not break.
- The body has very good elasticity.
- Connection without flange thanks to weldable PE pipe
- It has high resistance to chemicals.

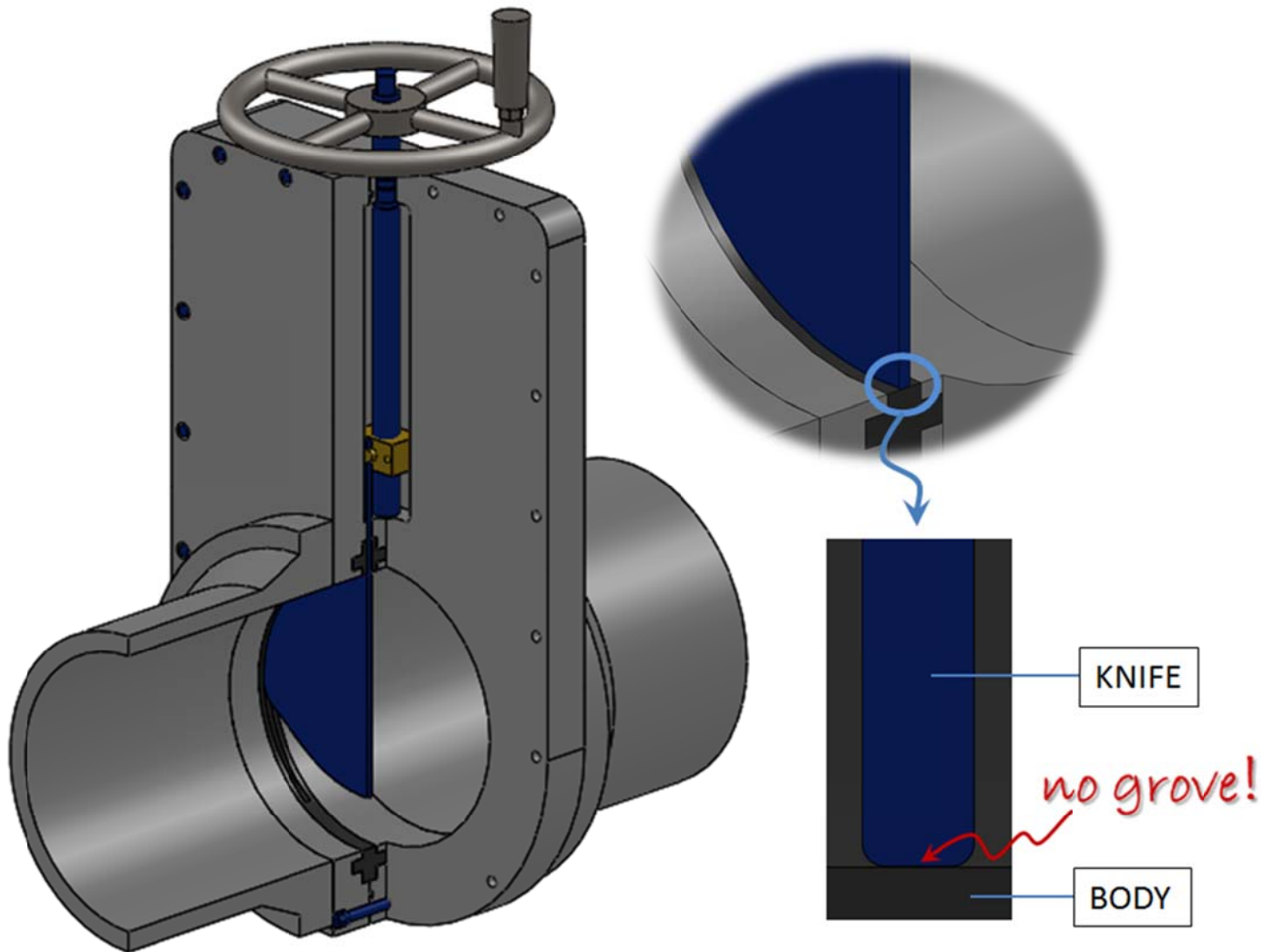

Efficiency losses are prevented by **no-groove** characteristic. Because of no groove, dust or any particle does not accumulate in the valve.

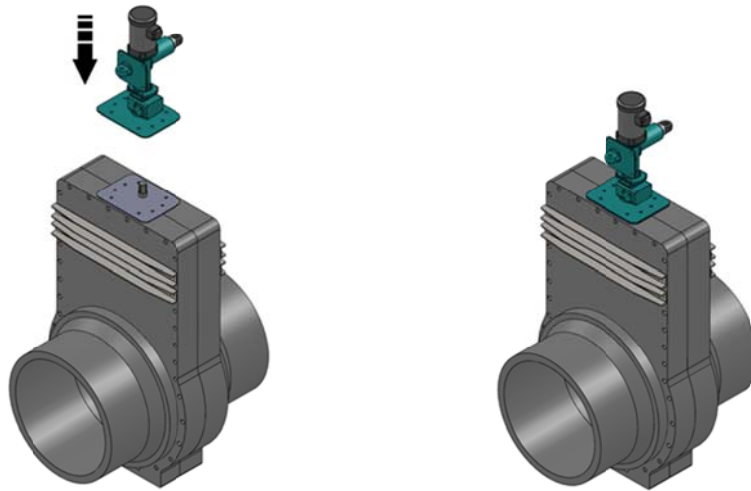

Ready montage points on the body, to be used  
TEGA Knife Valve with a Electrical Actuator..



## VALVE DETAILS

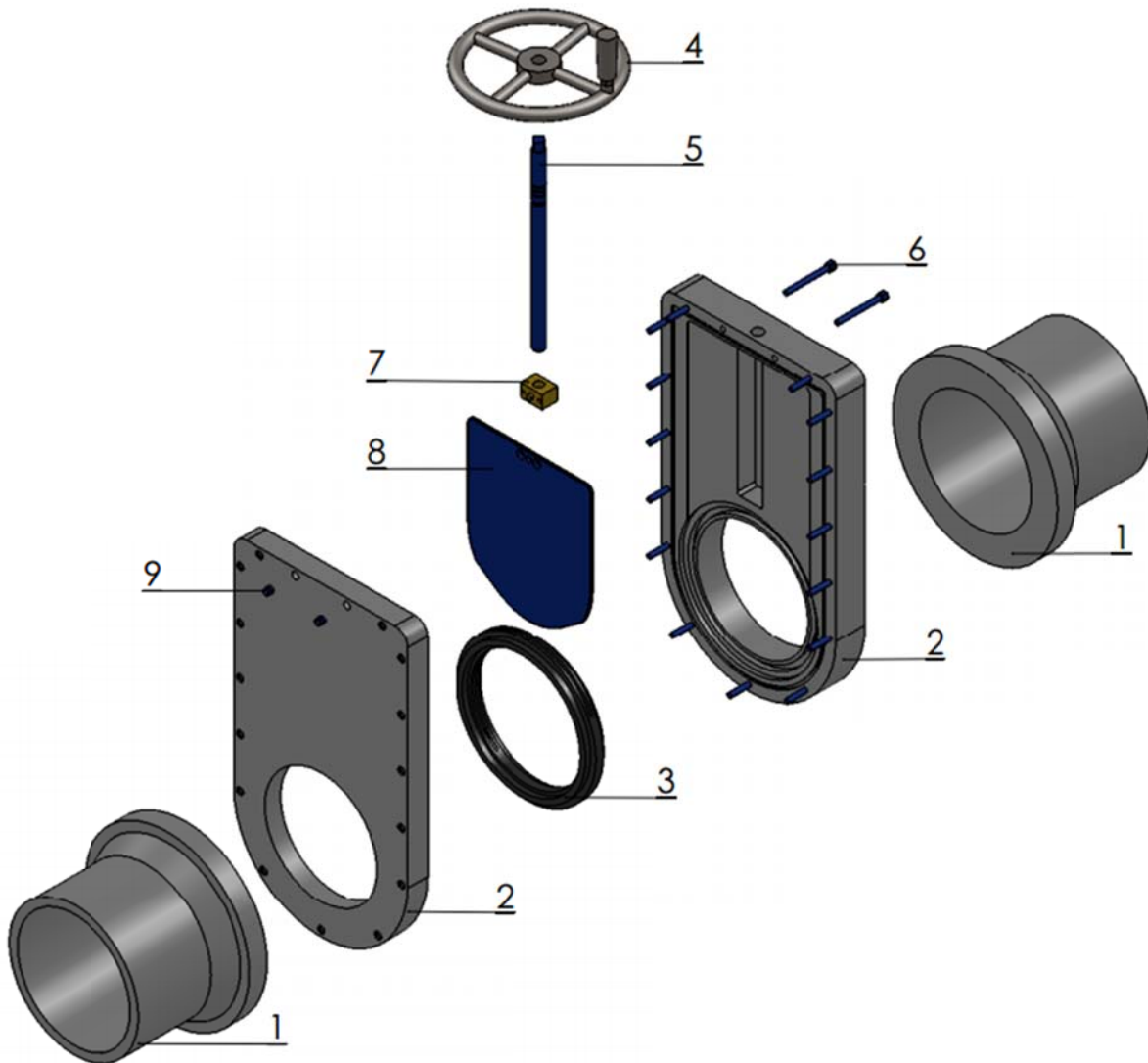

Parts	Materials
1 Valve Arm	Polyethylene
2 Body	Polyethylene
3 Gasket	Rubber
4 Flywheel	Cast Iron
5 Spindle	SS304/SS420
6 Bolt	Steel
7 Square Brass Gear	Brass
8 Knife	Composit
9 Nut	Steel

## TECHNICAL DRAWINGS

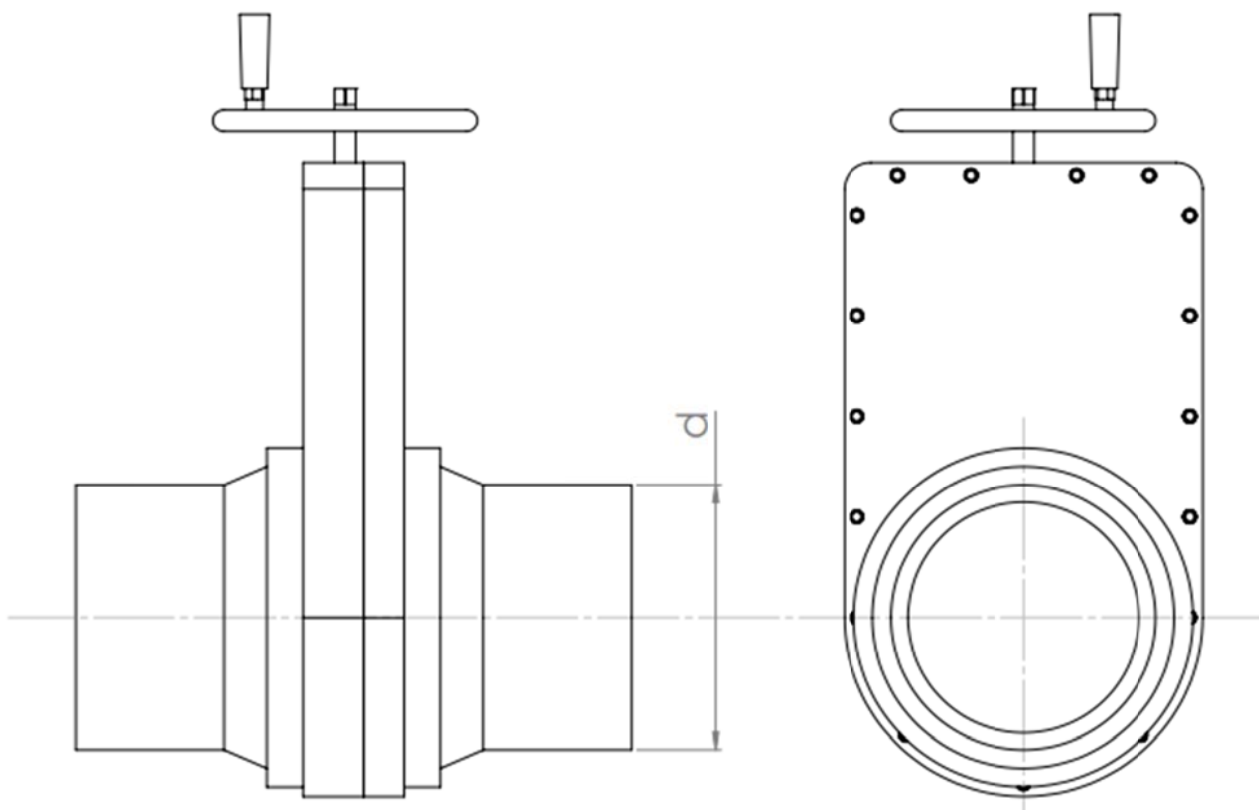

Available Sizes	PN
d110	6 bar
d125	
d160	
d200	
d250	
d315	
d400	2 bar
d500	
d630	
D710	
D800	